 <p>06/0712/--</p> <p>Stockton-on-Tees BOROUGH COUNCIL</p>	<p>This map is reproduced from Ordnance Survey material with the permission of Ordnance Survey on behalf of the Controller of Her Majesty's Stationary Office. © Crown Copyright. Unauthorised reproduction infringes Crown Copyright and may lead to prosecution or civil proceedings. Stockton-on-Tees Borough Council 100023297 2006</p>
<p>Carol Straughan Head of Planning Gloucester House, Church Road, Stockton-on-Tees, TS18 1TW Tel (01642) 526022 Fax (01642) 526048</p>	<p>Title Copeswood</p>
<p>Date</p>	<p>Scale 1:1250</p>

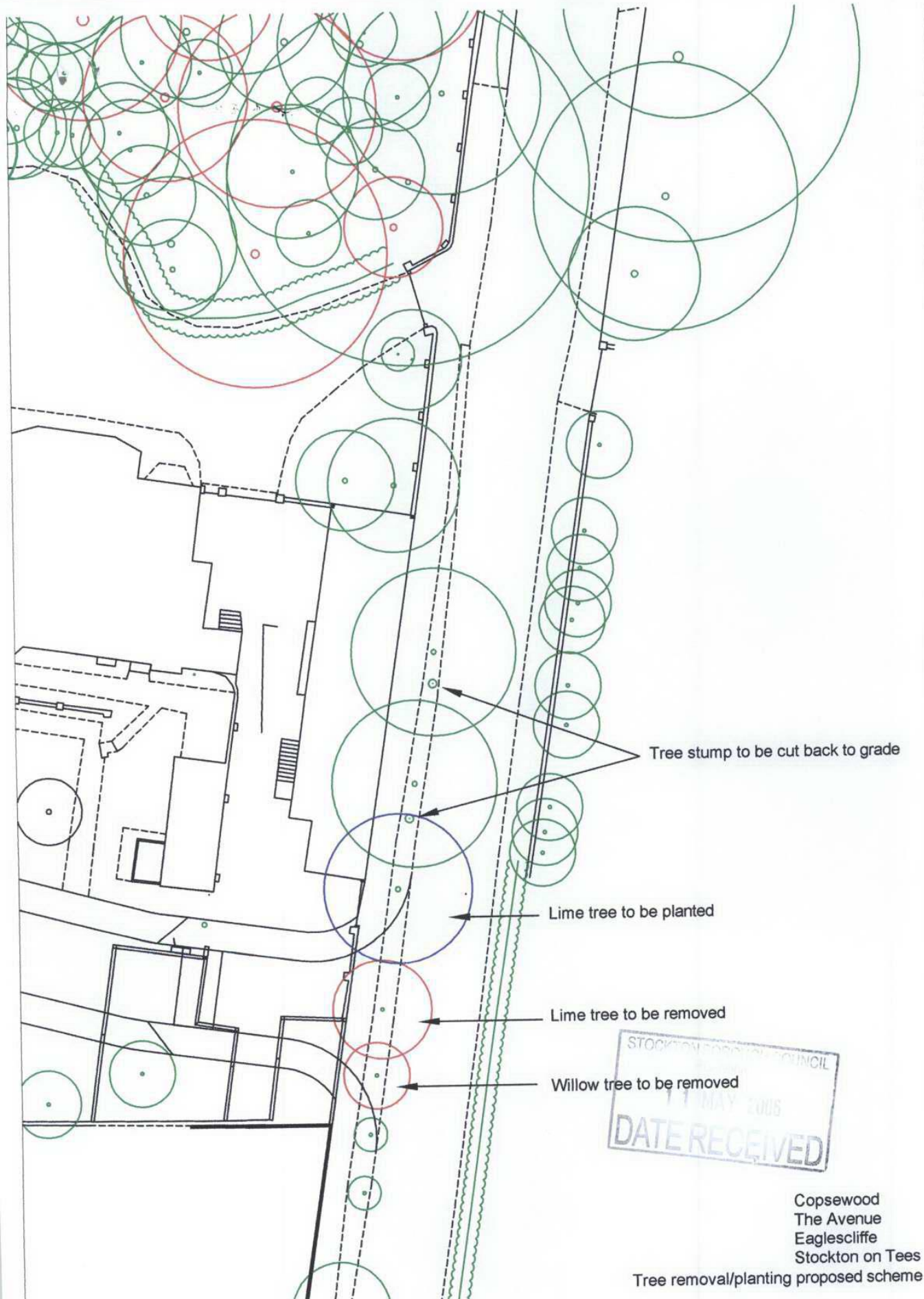

All levels are related to the Ordnance Survey Datum.
OSM value 24.98m, situated on bottom step of Village Hall Yarm Road



Sean McLean Design
 The Studio, 25 St Aidan's Crescent, Billingham, TS22 5AD
 Tel / Fax : 01642 555110 E-mail smdesign@tiscali.co.uk

PROPOSED DEVELOPMENTS AT
 COPSEWOOD, THE AVENUE, EAGLESCLIFFE
 STOCKTON FOR MR. MARK BARRETT

SCHEME A
 7 DETACHED DWELLINGS

Drng. No. 0578 / 01-A Date DEC 05

RECEIVED
 29 APR 2005
 PLANNING
 STOCKTON-ON-THE-AVENUE

LEGEND

PROTECTED TREE TO REMAIN

PROTECTED TREE TO BE REMOVED

NON-PROTECTED TREE TO REMAIN

YARM ROAD

COPSEWOOD

OUTLINE OF DWELLINGS AT REAR OF
 KIRKLANDS UNDER APPLICATION
 NUMBER 031716P BUT YET TO BE
 CONSTRUCTED

Existing trees to boundaries
 retained to prevent overlooking
 from proposed dwellings into
 gardens of dwellings granted
 planning permission but yet
 to be constructed

PROPOSED SITE PLAN (scale 1:500)